

MOTOMAN MS210

Spot Welding with the MS-series

The 6-axis MOTOMAN MS210 is a versatile, high speed robot offering superior performance in spot welding applications. The MOTOMAN MS210 offers a large motion range and is equipped with external cables for flexible mounting of large spot welding

guns, which contributes to increase the number of welding points per manipulator. The width of the MOTOMAN MS210 has been decreased by 625 mm and the installation area has also been reduced. In addition the payload has been increased to 210 kg. The number of power cables has been reduced from two to one resulting in reduced maintenance. A new vibration control system has been developed thanks to higher rotational axis speeds and rigidity of speed reducers. By reducing the cycle times, this system realises high increases in productivity.



KEY BENEFITS

- Fast, flexible and powerful
- High payload: 210 kg
- Wide motion range: 2702 mm
- Maximum performance using minimal floor space
- Equipped with media hose package for mounting spot welding guns
- Reduced maintenance (cable reduction from 2 to 1)

MOTOMAN MS210



Allowable wrist load

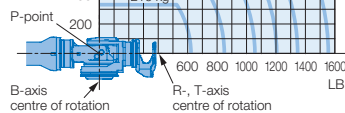
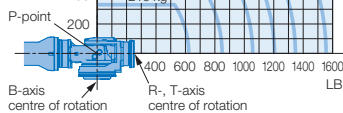

View A

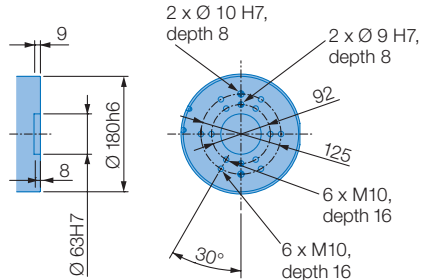

View B

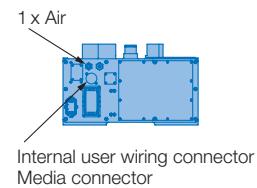

View C

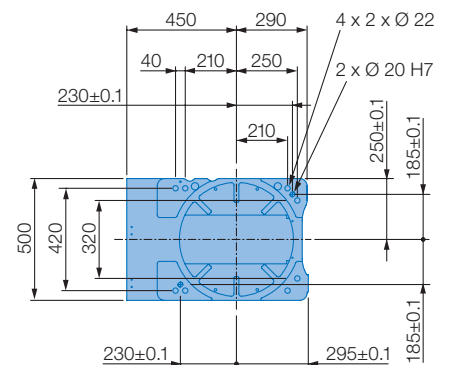

Mounting option: Floor
Protection class: IP54/67

All dimensions in mm | Technical data may be subject
to change without previous notice | Please request detailed
drawings at robotics@yaskawa.eu.com –
YR-MS00210-A00, E-04-2016, A-No. 163285

Specifications MS210

* Recommended values

Axes	Maximum motion range [°]		Maximum speed [°/sec.]		Allowable moment [Nm]		Allowable moment of inertia [kg · m²]		Flange	without	with
									Controlled axes		
Flange	without	with*	without	with	without	with	without	with	Max. payload [kg]	225	210
S	±180		120		–		–		Repeat. pos. accuracy [mm]	±0,2	
L	+76/–60		97		–		–		Max. working range R [mm]	2702	
U	+90/–147		115		–		–		Temperature [°C]	0 bis +45	
R	±360	±210	145		1372	1323	145	143	Humidity [%]	20 – 80	
B	±125		145		1372	1323	145	143	Weight [kg]	1000	
T	±360	±210	220		735		84		Power supply, average [KVA]	5,0	

YASKAWA
robotics@yaskawa.eu.com
www.yaskawa.eu.com

YASKAWA Headquarters
YASKAWA Europe GmbH · Robotics Division
Yaskawastraße 1 · D-85391 Allershausen
Tel. +49 (0) 8166/90-0 · Fax +49 (0) 8166/90-103

YASKAWA ACADEMY and sales office Frankfurt
YASKAWA Europe GmbH · Robotics Division
Hauptstraße 185 · D-65760 Eschborn
Tel. +49 (0) 6196/77725-0 · Fax +49 (0) 6196/77725-39